

# Installation Instructions

## Plain Cable

Pass one cable end through the DobyGrip in the direction of the arrow on the casing. **1**  
 Now pass the cable over or through the suspension point. Note: Always ensure that the suspension point is suitable and capable of supporting the load being suspended. Pass the cable back through the remaining entry into the DobyGrip unit **1** in the direction of the arrow on the casing then pull the cable **(B)** tight. Always ensure a minimum of **75mm** excess cable **(A)** protrudes through the unit. Pass the end of cable **(B)** through a second DobyGrip unit in the direction of the arrow on the casing. **2**

Pull the cable **(B)** through the unit and pass through the suspension point of the item being suspended ensuring that the contact point between the cable and the item being supported will not damage the cable. Pass the tail of the cable back through the remaining entry into the DobyGrip in the direction of the arrow on the casing leaving a minimum of **75mm** protruding from the DobyGrip. **3**

Pull the required length of cable through the unit to position the item being suspended at the desired height. The height can easily be adjusted by lifting the load from the DobyGrip, pushing back the adjusting slide \*lever and repositioning at the desired level.

\* Adjustment must be made using the main wire inward lever **(1)** on diagram to the right, **not** the lever where the wire is exiting the unit, prior to being cut. Once all heights are fixed excess cable can be cut back, always ensure a minimum of **75mm** excess cable protrudes through the unit.

## Safe Working Loading diagram (SWL)

The diagram below illustrates the typical loading configuration for the DobyGrip range when the suspension wire is away from vertical. If, as the diagram states, that the duct/pipe is required to be closer to the DobyGrip unit for height restrictions or services etc, then the Safe Working Load (SWL) table overleaf will show the permitted angles and the reduction in the suspended loads. For more information on DobyGrip suspension heights then please refer to the sales office for recommendations.

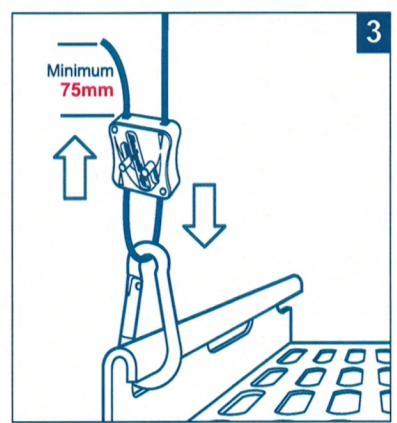
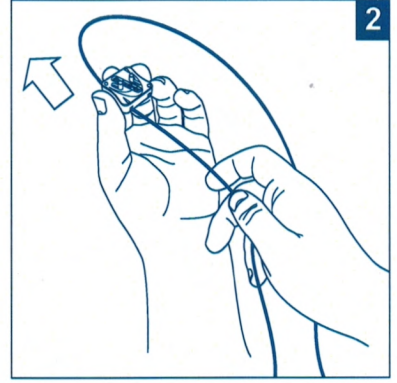
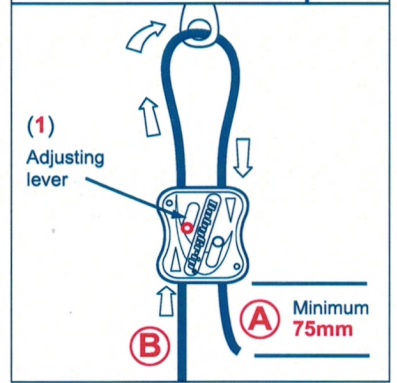
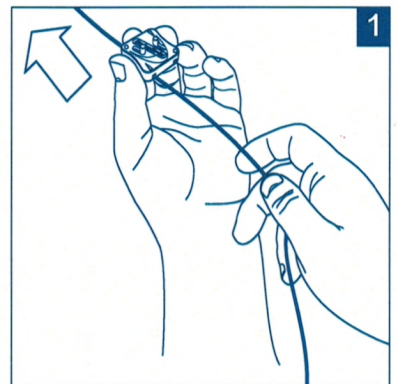
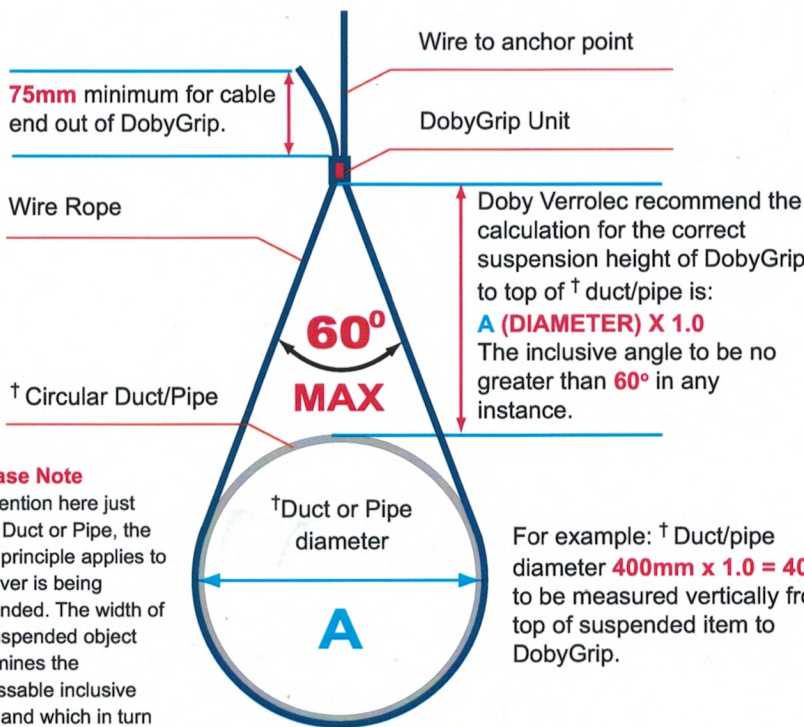

**WARNING**  
 Load ratings (SWL) are based on vertically suspended wire rope. If any part of the wire rope is NOT vertical refer to the safe working load table (SWL) or contact your local sales office for further information.

Installation Instructions